

**Heming, Mike**

---

**From:** Hirst, Chris <Chris.Hirst@hants.gov.uk>  
**Sent:** 20 February 2025 16:54  
**To:** David Stoddart  
**Cc:** JOwen@testvalley.gov.uk; SBarter@testvalley.gov.uk; Heming, Mike; Aldridge, Amy; Lee, Christien; Holloway, Katya; Mintram, Grant; Tonge, Nathan; Jason Tait; McCart, Gemma  
**Subject:** \*EXTERNAL:RE: Halterworth Lane, Romsey

**This Message Is From an External Sender**

This message came from outside your organization.

Hi David,

Thanks for sending over the comprehensive package of drawings detailing the proposed pedestrian and cycle upgrades to Botley Road, Halterworth Lane, Winchester Road and the canal towpath. These drawings have provided a useful basis for undertaking costing work for delivery of the works package.

As you have noted, Kings Chase Phase 2 has recently received planning permission, which included a contribution secured towards LCWIP improvements. These LCWIP routes are reflective of the site's location in Romsey, and I can confirm that there is no overlap with the proposals you are investigating in the area. Similarly, discussions with the Abbey Park applicant have centred around pedestrian and cycle improvements in the locale, and this section of the works have been omitted from the aforementioned costing work undertaken by the Highway Authority for the package of works you have designed. Again, this has been undertaken to ensure that no double counting is taking place.

There is no agreed position around the Whitenap application, but they have proposed a separate package of works which does not overlap with the areas you have investigated. As I have set out in previous correspondence, the Highway Authority has remained consistent in its approaches to applications in the area, ensuring that mitigation packages are reflective of the development's location and impact, and avoids any double counting.

Having costed the total package of works, this has come out at £4,289,984.20. Clearly, it would be disproportionate for the development to fund the entire works package.

To ensure that the contribution request meets the relevant tests of CIL, the Highway Authority requires a financial contribution of £1,746,533.08. This contribution figure is considered to be proportionate based on the package of works you have designed and is also reflective of the lack of wider capacity improvement works being put forward in light of LTP4 and the shift towards improvements to sustainable modes.

For clarity, I have set out what I consider to be the total highway works/mitigation package below:

- Payment of a TRO towards parking restrictions on Halterworth Lane.
- Delivery of the site access works onto Halterworth Lane.
- Payment of approval and monitoring fees, along with a cash deposit/bond for the Travel Plan (please see my comments below on the latter).

- Payment of a £1,746,533.08 contribution towards sustainable transport improvements identified in the drawings you have presented.

This would need to be refined to reflect drawing numbers etc. for the purposes of the S106, but I wanted to set this out so that we are all clear on what is being secured.

With regards to fund allocation for the Travel Plan, this will be managed in accordance with the TP action plan to ensure proportional spending. If the Appellant is predicting a slow rate of occupation, the TPC should still ensure that costs remain proportionate over the delivery of the TP. Are you able to provide any additional information regarding specific issues that the Appellant has faced in the past to clarify any potential misunderstandings?

Would it also be possible to confirm when you will be in a position to issue the highways specific SoCG?

I'm around tomorrow if there's anything you'd like to discuss.

Kind Regards,

**Chris Hirst**  
**Senior Transport Planner**  
[Chris.Hirst@hants.gov.uk](mailto:Chris.Hirst@hants.gov.uk)

**Highways Development Planning**  
 Hampshire County Council  
 2<sup>nd</sup> Floor Elizabeth II Court West  
 The Castle Winchester SO23 8UD



**Hampshire County Council operates a pre-application highway advice service for developers.**

Hampshire County Council welcomes and encourages discussions before a developer submits a planning application. Please follow this link for further information

[Pre-Application guidance for developers](#)

**From:** David Stoddart <D.Stoddart@primetp.co.uk>

**Sent:** 20 February 2025 11:46

**To:** Hirst, Chris <Chris.Hirst@hants.gov.uk>

**Cc:** JOwen@testvalley.gov.uk; SBarter@testvalley.gov.uk; Mike Heming <M.Heming@gladman.co.uk>; Amy Aldridge <A.Aldridge@gladman.co.uk>; C.Lee@gladman.co.uk; Holloway, Katya <katya.holloway@hants.gov.uk>; Mintram, Grant <Grant.Mintram@hants.gov.uk>; Tonge, Nathan <n.tonge@gladman.co.uk>; Jason Tait <Jason.Tait@planningprospects.co.uk>

**Subject:** RE: Halterworth Lane, Romsey

**Caution:** This is an external email and could contain malicious content. Do not open any links or attachments if you were not expecting them. If the e-mail looks suspicious, please report via the 'Report Phishing' Button found on your toolbar.

Hi Chris,

Just to add to the chain below, Whitenap have submitted the attached reps. As you will see, they have an interest in the highways related contributions requested from the appeal site and are keen for the double counting of them to be avoided. We believe that this is a fair request and the appellant also wants to see double counting avoided.

We are aware that HCC is seeking contributions from Whitenap, Kings Chase South and I recall you mentioned another development (possibly off Premier Way), as well as ours. There may indeed be others. When you come back to us with details of the contributions, I would be grateful if can explain where they sit “in-the-round” with the other applications and any other sources such as public funds. The clarity will also be of benefit to the Inspector and members of the public.

Kind regards

Dave

**David Stoddart**  
**Associate Director**

**D:** +44 (0)151 728 1864      **M:** +44 (0)7944 446 528

[www.primetp.co.uk](http://www.primetp.co.uk)



---

**From:** David Stoddart

**Sent:** 19 February 2025 17:14

**To:** 'Hirst, Chris' <[Chris.Hirst@hants.gov.uk](mailto:Chris.Hirst@hants.gov.uk)>

**Cc:** [JOwen@testvalley.gov.uk](mailto:JOwen@testvalley.gov.uk); [SBarter@testvalley.gov.uk](mailto:SBarter@testvalley.gov.uk); Mike Heming <[M.Heming@gladman.co.uk](mailto:M.Heming@gladman.co.uk)>; Amy Aldridge <[A.Aldridge@gladman.co.uk](mailto:A.Aldridge@gladman.co.uk)>; [C.Lee@gladman.co.uk](mailto:C.Lee@gladman.co.uk); Holloway, Katya <[katya.holloway@hants.gov.uk](mailto:katya.holloway@hants.gov.uk)>; Mintram, Grant <[Grant.Mintram@hants.gov.uk](mailto:Grant.Mintram@hants.gov.uk)>; Tonge, Nathan <[n.tonge@gladman.co.uk](mailto:n.tonge@gladman.co.uk)>

**Subject:** RE: Halterworth Lane, Romsey [Filed 19 Feb 2025 17:14]

Hi Chris,

Sorry for the delay in getting back to you. The £64,500 cost is agreeable in principle with the appellant, however, they have experienced issues with travel plan related costs at a previous appeal, where the Inspector expressed concern regarding timescales for the delivery of travel plan measures. They noted that in year 1, potentially only a very small number of dwellings may be occupied, so the costs would not be proportionate compared to other years.

Would it be possible to provide some further explanation as to how the costs would be allocated? Perhaps there would be a trigger point? I trust HCC have a standard practice when it comes to managing these funds?

Also, on a separate matter, I noted that our swept path drawing P21004-006A 'SWEPT PATH ANALYSIS OF SOUTHERN ACCESS POINT', sent to you via email on 7<sup>th</sup> February 2025, was incorrectly titled as it referred to the southern access. The attached revision P21004-006B titled 'SWEPT PATH ANALYSIS BETWEEN NORTHERN ACCESS AND SAXON WAY' supersedes the previous one. The only change is the corrected title.

Kind regards

Dave

**David Stoddart**  
**Associate Director**



---

**From:** Hirst, Chris <[Chris.Hirst@hants.gov.uk](mailto:Chris.Hirst@hants.gov.uk)>

**Sent:** 13 February 2025 11:41

**To:** David Stoddart <[D.Stoddart@primetp.co.uk](mailto:D.Stoddart@primetp.co.uk)>

**Cc:** [JOwen@testvalley.gov.uk](mailto:JOwen@testvalley.gov.uk); [SBarter@testvalley.gov.uk](mailto:SBarter@testvalley.gov.uk); Mike Heming <[M.Heming@gladman.co.uk](mailto:M.Heming@gladman.co.uk)>; Amy Aldridge <[A.Aldridge@gladman.co.uk](mailto:A.Aldridge@gladman.co.uk)>; [C.Lee@gladman.co.uk](mailto:C.Lee@gladman.co.uk); Holloway, Katya <[katya.holloway@hants.gov.uk](mailto:katya.holloway@hants.gov.uk)>; Mintram, Grant <[Grant.Mintram@hants.gov.uk](mailto:Grant.Mintram@hants.gov.uk)>; Tonge, Nathan <[n.tonge@gladman.co.uk](mailto:n.tonge@gladman.co.uk)>

**Subject:** RE: Halterworth Lane, Romsey [Filed 14 Feb 2025 15:25]

Hi David,

Apologies for coming back again on the Travel Plan; however, after seeking confirmation that the TP is now agreed following our exchange below, the officer reviewing the plan has highlighted that they want to ensure that the team does not run out of funds for the surveys and welcome packs over time. These costs therefore need to be accounted for annually, which would increase the cash deposit/bond value total to £64,500. The breakdown would be as follows:

**TPC annual salary** (part-time responsibility alongside other roles): £6,000 x 5 = £30,000

**Travel voucher cost** (towards public transport tickets or cycling equipment): £50 per household = £13,500

**Printing costs for welcome packs:** £400 x 5 = £2,000

**Turning count survey costs at site accesses** (required annually): £1,000 x 5 = £5,000

**Residential travel questionnaire cost** (required annually): £10 per household plus £100 incentive = £2,800 x 5 = £14,000

Please can you confirm whether you are satisfied with the above value being secured within the S106 agreement?

Kind Regards,

**Chris Hirst**

**Senior Transport Planner**

[Chris.Hirst@hants.gov.uk](mailto:Chris.Hirst@hants.gov.uk)

**Highways Development Planning**

Hampshire County Council

2<sup>nd</sup> Floor Elizabeth II Court West

The Castle Winchester SO23 8UD



Hampshire County Council operates a pre-application highway advice service for developers.

Hampshire County Council welcomes and encourages discussions before a developer submits a planning application. Please follow this link for further information

[Pre-Application guidance for developers](#)

---

**From:** David Stoddart <[D.Stoddart@primetp.co.uk](mailto:D.Stoddart@primetp.co.uk)>

**Sent:** 12 February 2025 14:46

**To:** Hirst, Chris <[Chris.Hirst@hants.gov.uk](mailto:Chris.Hirst@hants.gov.uk)>

**Cc:** [JOwen@testvalley.gov.uk](mailto:JOwen@testvalley.gov.uk); [SBarter@testvalley.gov.uk](mailto:SBarter@testvalley.gov.uk); Mike Heming <[M.Heming@gladman.co.uk](mailto:M.Heming@gladman.co.uk)>; Amy Aldridge <[A.Aldridge@gladman.co.uk](mailto:A.Aldridge@gladman.co.uk)>; [C.Lee@gladman.co.uk](mailto:C.Lee@gladman.co.uk); Holloway, Katya <[katya.holloway@hants.gov.uk](mailto:katya.holloway@hants.gov.uk)>; Mintram, Grant <[Grant.Mintram@hants.gov.uk](mailto:Grant.Mintram@hants.gov.uk)>; Tonge, Nathan <[n.tonge@gladman.co.uk](mailto:n.tonge@gladman.co.uk)>

**Subject:** RE: Halterworth Lane, Romsey

**Caution:** This is an external email and could contain malicious content. Do not open any links or attachments if you were not expecting them. If the e-mail looks suspicious, please report via the 'Report Phishing' Button found on your toolbar.

Hi Chris,

Just following your query on the Travel Plan budget in your email on 6<sup>th</sup> February, for completeness, please find attached Revision C of the document that clarifies this figure in paras 8.5.3 and 8.5.4. These are the only changes other than reference to the revision on the document control sheet and in the introduction.

Kind regards

Dave

**David Stoddart**

**Associate Director**

**D:** +44 (0)151 728 1864      **M:** +44 (0)7944 446 528

[www.primetp.co.uk](http://www.primetp.co.uk)



---

**From:** David Stoddart

**Sent:** 07 February 2025 14:37

**To:** 'Hirst, Chris' <[Chris.Hirst@hants.gov.uk](mailto:Chris.Hirst@hants.gov.uk)>

**Cc:** [JOwen@testvalley.gov.uk](mailto:JOwen@testvalley.gov.uk); [SBarter@testvalley.gov.uk](mailto:SBarter@testvalley.gov.uk); Mike Heming <[M.Heming@gladman.co.uk](mailto:M.Heming@gladman.co.uk)>; Amy Aldridge <[A.Aldridge@gladman.co.uk](mailto:A.Aldridge@gladman.co.uk)>; [C.Lee@gladman.co.uk](mailto:C.Lee@gladman.co.uk); Holloway, Katya <[katya.holloway@hants.gov.uk](mailto:katya.holloway@hants.gov.uk)>; Mintram, Grant <[Grant.Mintram@hants.gov.uk](mailto:Grant.Mintram@hants.gov.uk)>; Tonge, Nathan <[n.tonge@gladman.co.uk](mailto:n.tonge@gladman.co.uk)>

**Subject:** RE: Halterworth Lane, Romsey [Filed 07 Feb 2025 14:37]

Hi Chris,

Many thanks for getting back to me following your review of the additional/updated documents.

**TRO & Parking**

We will get back to you with some suggesting wording for the park and stride condition.

**Access**

Please find attached an updated suite of access drawings. The only updates are the inclusion of highway boundary, along with a second pair of windows added to the swept path analysis shown in P21004-006A to include the refuse collection vehicle making the cross movement between Saxon Way and the proposed northern site access.

### **Travel Plan**

With regards to the Travel Plan, the salary figure for the TPC is £6,000 per year, so for five years this is £30,000. This figure added to the budget for the measures equates to the £47,700 you have identified. We believe this figure is comparable with the £51,220 calculated for the Kings Chase South TP (309 dwellings).

### **Offsite Works**

I'm pleased to also attach the initial versions of the preliminary designs for the LCWIP based walking and cycling improvements. As previously discussed, we've used the suggestions and aspirations of the LCWIP as a starting point but also added our own suggestions, mainly as some of those in the LCWIP don't look feasible. I've attached the relevant LCWIP extracts so you can see what has guided us. As previously agreed, we have considered the sections of the LCWIP routes in proximity to the site except for those that Whitenap has already considered. I feel that our designs will tie-in well with what Whitenap has suggested.

From my understanding, the core points from the LCWIP and HCC design guidance are that separate cycleways and footways should be provided (not shared facilities) and where there are constraints, the infrastructure provision shouldn't require crossing from one side to the other frequently. In instances of the latter, the preference is for the implementation of a 20mph speed limit and traffic calming features to support this. We further understand that HCC does not favour vertical deflection (speed cushions, humps, bumps etc) due to maintenance liabilities so we have considered horizontal deflection in the form of build-outs/narrowings, taking inspiration from existing features on Botley Road. This predominantly applies to the section of Botley Road west of Halterworth Lane where the verges are too narrow to provide a separate cycleway (Sheet 2) and Halterworth Lane (Sheet 3).

We've suggested toucan crossings on Botley Road and Winchester Road, this is because Active Travel England's advice in its Crossing Selector Tool (which is more recent than the LCWIP) is for crossings to be signal controlled on roads where the daily volume of traffic exceeds 8,000 vehicles per day, which would be the case on both roads. We've also suggested some junction tightening and additional tactile paving to aid pedestrian movements.

On the right-hand window of Sheet 3, we undertook title searches for the land around Campion Drive and Bramble Drive. The main parcels are owned by HCC and TVBC but the bend in the traffic-free path is owned by the adjacent properties so we've suggested two alternative routes, though the constrained section would be only across a fairly short length (<20m).

On Sheet 4, which shows the canal towpath route to the train station, the suggestion in the LCWIP was to cantilever the towpath and/or use third party land which I really don't think is workable. You will see that we have suggested that Mountbatten Avenue could be an alternative route, with it being a lightly trafficked residential street.

As these are preliminary drawings, further work will need to be done to fully consider property boundaries, impact on tree roots and the presence of utilities. But for now, I trust they are a reasonable basis for your authority to cost for S106 purposes.

Feel free to drop me a line if you require any further details of the LCWIP based improvements.

We will come back to you on the parking condition and with a draft Highways SoCG.

Kind regards

Dave

**David Stoddart**  
Associate Director



---

**From:** Hirst, Chris <[Chris.Hirst@hants.gov.uk](mailto:Chris.Hirst@hants.gov.uk)>

**Sent:** 06 February 2025 15:47

**To:** David Stoddart <[D.Stoddart@primetp.co.uk](mailto:D.Stoddart@primetp.co.uk)>

**Cc:** [JOwen@testvalley.gov.uk](mailto:JOwen@testvalley.gov.uk); [SBarter@testvalley.gov.uk](mailto:SBarter@testvalley.gov.uk); Mike Heming <[M.Heming@gladman.co.uk](mailto:M.Heming@gladman.co.uk)>;

Amy Aldridge <[A.Aldridge@gladman.co.uk](mailto:A.Aldridge@gladman.co.uk)>; [C.Lee@gladman.co.uk](mailto:C.Lee@gladman.co.uk); Holloway, Katya

<[katya.holloway@hants.gov.uk](mailto:katya.holloway@hants.gov.uk)>; Mintram, Grant <[Grant.Mintram@hants.gov.uk](mailto:Grant.Mintram@hants.gov.uk)>

**Subject:** RE: Halterworth Lane, Romsey

Hi David,

I have now had the chance to run through TN1 and the updated FTP you have recently provided. Whilst most matters have generally been addressed, I require a few points of clarity/detail which are set out below.

### **TRO & Parking**

It is agreed that parking restrictions will need to be implemented at the new site accesses, alongside an extension to the existing parking restrictions on Halterworth Lane. This is to improve the conditions in and around Halterworth School during the drop off and pick up times when on street parking obstructs the free flow of traffic and results in delays which would be exacerbated by the proposed development. To offset the loss of parking and encourage children to walk and wheel to school, the Highway Authority requires a park and stride site to be provided within the development. I am happy for the exact location and scale of the car park to be subject to a suitably worded condition to address through the Reserved Matters stage.

### **Access**

The principle of the accesses is now considered acceptable; however, please can you overlay the highway boundary to confirm that both junctions and the associated visibility splays sit wholly within your client's/highway land. Please can you also track a refuse vehicle egressing Saxon Way and entering the development (and vice versa) as this movement is considered a more frequent/likely occurrence than an articulated vehicle which cannot make the movement without significant overhang of the carriageway.

### **Public Rights of Way**

I have spoken to the Countryside officer dealing with this appeal who is CC'd for awareness. He will respond separately to Sarah regarding his requirements in relation to the PRoW network.

### **Travel Plan**

The Travel Plan is primarily agreed, subject to confirmation regarding the final cost estimate. Taking account of the measures set out under Section 8.5.3 this would place the figure at **£47,700**. Please can you confirm that this is correct?

### **Offsite Works**

As previously noted, a fair and proportionate contribution towards offsite mitigation measures will be reviewed and discussed upon receipt of the drawings you are currently pulling together.



Finally, please can you prepare a Statement of Common Ground to circulate. I will revert back on the document with any required amends before this is agreed.

Kind Regards,

**Chris Hirst**  
**Senior Transport Planner**  
[Chris.Hirst@hants.gov.uk](mailto:Chris.Hirst@hants.gov.uk)

**Highways Development Planning**  
Hampshire County Council  
2<sup>nd</sup> Floor Elizabeth II Court West  
The Castle Winchester SO23 8UD



**Hampshire County Council operates a pre-application highway advice service for developers.**

Hampshire County Council welcomes and encourages discussions before a developer submits a planning application. Please follow this link for further information

[Pre-Application guidance for developers](#)

---

**From:** Hirst, Chris  
**Sent:** 03 February 2025 15:38  
**To:** David Stoddart <[D.Stoddart@primetp.co.uk](mailto:D.Stoddart@primetp.co.uk)>  
**Cc:** [JOwen@testvalley.gov.uk](mailto:JOwen@testvalley.gov.uk); [SBarter@testvalley.gov.uk](mailto:SBarter@testvalley.gov.uk); Mike Heming <[M.Heming@gladman.co.uk](mailto:M.Heming@gladman.co.uk)>; Amy Aldridge <[A.Aldridge@gladman.co.uk](mailto:A.Aldridge@gladman.co.uk)>; [C.Lee@gladman.co.uk](mailto:C.Lee@gladman.co.uk); Holloway, Katya <[katya.holloway@hants.gov.uk](mailto:katya.holloway@hants.gov.uk)>  
**Subject:** RE: Halterworth Lane, Romsey

Hi David,

With regards to your query concerning the contribution secured from the Kings Chase application, this was calculated based on the agreed contribution value from Phase 1. Each site must be assessed on the specific infrastructure requirements, based on location, adequacy of existing conditions etc. In this case, given also the commitment to deliver a cycle connection through the site and a crossing on A3090, the contribution value was considered to be fair and reasonable given the work undertaken through Phase 1, and the LCWIP routes into Romsey town centre. Given the history to these developments, the situation at Kings Chase is slightly different and does not set a precedent for the area.

The request made for you to produce design work is consistent with approach at the nearby Abbey Park and Whitenap developments for which this is also considered necessary. The Highway Authority is therefore adopting a consistent approach with applicants to ensure that suitable mitigation is identified and secured through subsequent S106 agreements.

I trust that the above is clear and look forward to receiving the offsite works drawings this week.

Kind Regards,

**Chris Hirst**  
**Senior Transport Planner**



[Chris.Hirst@hants.gov.uk](mailto:Chris.Hirst@hants.gov.uk)

## Highways Development Planning

Hampshire County Council  
2<sup>nd</sup> Floor Elizabeth II Court West  
The Castle Winchester SO23 8UD



### Hampshire County Council operates a pre-application highway advice service for developers.

Hampshire County Council welcomes and encourages discussions before a developer submits a planning application. Please follow this link for further information

[Pre-Application guidance for developers](#)

---

**From:** David Stoddart <[D.Stoddart@primetp.co.uk](mailto:D.Stoddart@primetp.co.uk)>

**Sent:** 03 February 2025 10:53

**To:** Hirst, Chris <[Chris.Hirst@hants.gov.uk](mailto:Chris.Hirst@hants.gov.uk)>

**Cc:** [JOwen@testvalley.gov.uk](mailto:JOwen@testvalley.gov.uk); [SBarter@testvalley.gov.uk](mailto:SBarter@testvalley.gov.uk); Mike Heming <[M.Heming@gladman.co.uk](mailto:M.Heming@gladman.co.uk)>; Amy Aldridge <[A.Aldridge@gladman.co.uk](mailto:A.Aldridge@gladman.co.uk)>; [C.Lee@gladman.co.uk](mailto:C.Lee@gladman.co.uk); Holloway, Katya <[katya.holloway@hants.gov.uk](mailto:katya.holloway@hants.gov.uk)>

**Subject:** RE: Halterworth Lane, Romsey

**Caution:** This is an external email and could contain malicious content. Do not open any links or attachments if you were not expecting them. If the e-mail looks suspicious, please report via the 'Report Phishing' Button found on your toolbar.

Hi Chris,

We have an initial draft of the drawings almost ready. We will be sharing them with Gladman in the next couple days for their review, before hopefully providing them to you before the end of the week.

Just as a point of note, I reviewed the 309 dwelling Barratt & David Wilson Homes outline application, known as Kings Chase South (23/00964/OUTS), and a request from your authority (March 2024 consultation response attached) was:

*'A financial contribution of £672,410 towards improvements to pedestrian and cycle infrastructure in line with the Test Valley LCWIP.'*

I note that the officer report to planning committee (dated 4<sup>th</sup> Feb 2025 on the planning portal) references the contribution though it does not state the figure.

I have not seen any evidence of design work informing this LCWIP contribution so I would be interested to hear more on the mechanism used to calculate it. There is obviously scope for debate regarding our design work, but I would like to think that your authority may be in a position to consider a commensurate level contribution to the LCWIP regardless of the outcome of the drawings.

Kind regards

Dave

**David Stoddart**

**Associate Director**

**D:** +44 (0)151 728 1864

**M:** +44 (0)7944 446 528

[www.primetp.co.uk](http://www.primetp.co.uk)



---

**From:** Hirst, Chris <[Chris.Hirst@hants.gov.uk](mailto:Chris.Hirst@hants.gov.uk)>

**Sent:** 02 February 2025 19:36

**To:** David Stoddart <[D.Stoddart@primetp.co.uk](mailto:D.Stoddart@primetp.co.uk)>

**Cc:** [JOwen@testvalley.gov.uk](mailto:JOwen@testvalley.gov.uk); [SBarter@testvalley.gov.uk](mailto:SBarter@testvalley.gov.uk); Mike Heming <[M.Heming@gladman.co.uk](mailto:M.Heming@gladman.co.uk)>; Amy Aldridge <[A.Aldridge@gladman.co.uk](mailto:A.Aldridge@gladman.co.uk)>; [C.Lee@gladman.co.uk](mailto:C.Lee@gladman.co.uk); Holloway, Katya <[katya.holloway@hants.gov.uk](mailto:katya.holloway@hants.gov.uk)>

**Subject:** RE: Halterworth Lane, Romsey

Hi David,

Please can you provide an update as to when you'll be in a position to issue the improvement scheme drawings?

As you are aware, timescales are tight for reviewing and discussing responses to the latest information, and I am conscious that the offsite works will form a significant part of these conversations.

I will come back to you early next week regarding the technical note and updated FTP.

Kind Regards,

**Chris Hirst**

**Senior Transport Planner**

[Chris.Hirst@hants.gov.uk](mailto:Chris.Hirst@hants.gov.uk)

**Highways Development Planning**

Hampshire County Council

2<sup>nd</sup> Floor Elizabeth II Court West

The Castle Winchester SO23 8UD



**Hampshire County Council operates a pre-application highway advice service for developers.**

Hampshire County Council welcomes and encourages discussions before a developer submits a planning application. Please follow this link for further information

[Pre-Application guidance for developers](#)

---

**From:** David Stoddart <[D.Stoddart@primetp.co.uk](mailto:D.Stoddart@primetp.co.uk)>

**Sent:** 28 January 2025 16:12

**To:** Hirst, Chris <[Chris.Hirst@hants.gov.uk](mailto:Chris.Hirst@hants.gov.uk)>

**Cc:** [JOwen@testvalley.gov.uk](mailto:JOwen@testvalley.gov.uk); [SBarter@testvalley.gov.uk](mailto:SBarter@testvalley.gov.uk); Mike Heming <[M.Heming@gladman.co.uk](mailto:M.Heming@gladman.co.uk)>; Amy Aldridge <[A.Aldridge@gladman.co.uk](mailto:A.Aldridge@gladman.co.uk)>; [C.Lee@gladman.co.uk](mailto:C.Lee@gladman.co.uk); Holloway, Katya <[katya.holloway@hants.gov.uk](mailto:katya.holloway@hants.gov.uk)>

**Subject:** RE: Halterworth Lane, Romsey

**Caution:** This is an external email and could contain malicious content. Do not open any links or attachments if you were not expecting them. If the e-mail looks suspicious, please report via the 'Report Phishing' Button found on your toolbar.

Good afternoon Chris,

Please find attached Revision B of the Travel Plan which hopefully addresses the comments in HCC's consultation response. We are of course expecting a condition requiring a full Travel Plan to be submitted at the appropriate stage.

We are well underway with the LCWIP based improvement drawings. We should hopefully have an initial set of drawings for you in the next few days.

Kind regards

Dave

**David Stoddart**

**Associate Director**

**D:** +44 (0)151 728 1864

**M:** +44 (0)7944 446 528

[www.primetp.co.uk](http://www.primetp.co.uk)



---

**From:** Hirst, Chris <[Chris.Hirst@hants.gov.uk](mailto:Chris.Hirst@hants.gov.uk)>

**Sent:** 27 January 2025 12:13

**To:** David Stoddart <[D.Stoddart@primetp.co.uk](mailto:D.Stoddart@primetp.co.uk)>

**Cc:** [JOwen@testvalley.gov.uk](mailto:JOwen@testvalley.gov.uk); [SBarter@testvalley.gov.uk](mailto:SBarter@testvalley.gov.uk); Mike Heming [M.Heming@gladman.co.uk](mailto:M.Heming@gladman.co.uk); Amy Aldridge [A.Aldridge@gladman.co.uk](mailto:A.Aldridge@gladman.co.uk); [C.Lee@gladman.co.uk](mailto:C.Lee@gladman.co.uk); Holloway, Katya <[katya.holloway@hants.gov.uk](mailto:katya.holloway@hants.gov.uk)>

**Subject:** RE: Halterworth Lane, Romsey

Hi David,

Thanks for sending over the Technical Note, which I have started to review.

I will take a look through the Travel Plan and offsite work drawings as and when they are sent across.

Kind Regards,

**Chris Hirst**

**Senior Transport Planner**

[Chris.Hirst@hants.gov.uk](mailto:Chris.Hirst@hants.gov.uk)

**Highways Development Planning**

Hampshire County Council

2<sup>nd</sup> Floor Elizabeth II Court West



**Hampshire County Council operates a pre-application highway advice service for developers.**

Hampshire County Council welcomes and encourages discussions before a developer submits a planning application. Please follow this link for further information

[Pre-Application guidance for developers](#)

---

**From:** David Stoddart <[D.Stoddart@primetp.co.uk](mailto:D.Stoddart@primetp.co.uk)>

**Sent:** 24 January 2025 17:47

**To:** Hirst, Chris <[Chris.Hirst@hants.gov.uk](mailto:Chris.Hirst@hants.gov.uk)>

**Cc:** [JOwen@testvalley.gov.uk](mailto:JOwen@testvalley.gov.uk); [SBarter@testvalley.gov.uk](mailto:SBarter@testvalley.gov.uk); Mike Heming <[M.Heming@gladman.co.uk](mailto:M.Heming@gladman.co.uk)>; Amy Aldridge <[A.Aldridge@gladman.co.uk](mailto:A.Aldridge@gladman.co.uk)>; [C.Lee@gladman.co.uk](mailto:C.Lee@gladman.co.uk); Holloway, Katya <[katya.holloway@hants.gov.uk](mailto:katya.holloway@hants.gov.uk)>

**Subject:** RE: Halterworth Lane, Romsey

**Caution:** This is an external email and could contain malicious content. Do not open any links or attachments if you were not expecting them. If the e-mail looks suspicious, please report via the 'Report Phishing' Button found on your toolbar.

Hi Chris,

Sorry this is slightly later than planned, but please find attached our Transport Technical Note 1 which should hopefully address many of the outstanding issues raised in HCC's consultation response. Appended to the report is an updated suite of access drawings which include relatively minor amendments to those previously submitted with the application.

I will provide you with an updated Travel Plan early next week with our walking and cycling improvement drawings to follow later in the week.

I'm happy to discuss the content of the Technical Note over the phone or via Teams should you have any questions.

Kind regards

Dave

**David Stoddart**

**Associate Director**

**D:** +44 (0)151 728 1864

**M:** +44 (0)7944 446 528

[www.primetp.co.uk](http://www.primetp.co.uk)



---

**From:** Hirst, Chris <[Chris.Hirst@hants.gov.uk](mailto:Chris.Hirst@hants.gov.uk)>

**Sent:** 21 January 2025 09:14

**To:** David Stoddart <[D.Stoddart@primetp.co.uk](mailto:D.Stoddart@primetp.co.uk)>

**Cc:** [JOwen@testvalley.gov.uk](mailto:JOwen@testvalley.gov.uk); [SBarter@testvalley.gov.uk](mailto:SBarter@testvalley.gov.uk); Mike Heming <[M.Heming@gladman.co.uk](mailto:M.Heming@gladman.co.uk)>; Amy Aldridge

<[A.Aldridge@gladman.co.uk](mailto:A.Aldridge@gladman.co.uk)>; [C.Lee@gladman.co.uk](mailto:C.Lee@gladman.co.uk); Holloway, Katya <[katya.holloway@hants.gov.uk](mailto:katya.holloway@hants.gov.uk)>

**Subject:** RE: Halterworth Lane, Romsey

Hi David,

Thanks for the update and noted regarding the timescales for provision of the additional information.

Look forward to hearing from you in due course.

Kind Regards,

**Chris Hirst**  
**Senior Transport Planner**  
[Chris.Hirst@hants.gov.uk](mailto:Chris.Hirst@hants.gov.uk)

**Highways Development Planning**  
Hampshire County Council  
2<sup>nd</sup> Floor Elizabeth II Court West  
The Castle Winchester SO23 8UD



Hampshire  
County Council

**Hampshire County Council operates a pre-application highway advice service for developers.**

Hampshire County Council welcomes and encourages discussions before a developer submits a planning application. Please follow this link for further information

[Pre-Application guidance for developers](#)

---

**From:** David Stoddart <[D.Stoddart@primetp.co.uk](mailto:D.Stoddart@primetp.co.uk)>

**Sent:** 17 January 2025 16:13

**To:** Hirst, Chris <[Chris.Hirst@hants.gov.uk](mailto:Chris.Hirst@hants.gov.uk)>

**Cc:** [JOwen@testvalley.gov.uk](mailto:JOwen@testvalley.gov.uk); [SBarter@testvalley.gov.uk](mailto:SBarter@testvalley.gov.uk); Mike Heming <[M.Heming@gladman.co.uk](mailto:M.Heming@gladman.co.uk)>; Amy Aldridge <[A.Aldridge@gladman.co.uk](mailto:A.Aldridge@gladman.co.uk)>; [C.Lee@gladman.co.uk](mailto:C.Lee@gladman.co.uk); Brown, Harry <[Harry.Brown2@hants.gov.uk](mailto:Harry.Brown2@hants.gov.uk)>

**Subject:** RE: Halterworth Lane, Romsey

**Caution:** This is an external email and could contain malicious content. Do not open any links or attachments if you were not expecting them. If the e-mail looks suspicious, please report via the 'Report Phishing' Button found on your toolbar.

Hi Chris,

Happy New Year to you too. The break seems like a very long time ago now!

I have been asked to copy Jason and Sarah into all of our future correspondence. I have also included the planning team at Gladman.

I am currently preparing a fairly concise Technical Note that addresses the items raised in HCC's consultation response from March 2024. This will include an updated suite of access drawings with very minor revisions. I am also

updating the Travel Plan in line with the consultation response. Both documents should hopefully be ready for your review early to mid-next week.

The appellant has commissioned a topo survey for the extent of the walking and cycling routes we discussed. We have now received the topo survey and will be producing preliminary design drawings. We are aiming to have an initial package ready towards the end of next week, though it may fall into w/c 27<sup>th</sup> January.

Kind regards

Dave

**David Stoddart**  
**Associate Director**

**D:** +44 (0)151 728 1864      **M:** +44 (0)7944 446 528

[www.primetp.co.uk](http://www.primetp.co.uk)

---

**From:** Hirst, Chris <[Chris.Hirst@hants.gov.uk](mailto:Chris.Hirst@hants.gov.uk)>  
**Sent:** 15 January 2025 08:48  
**To:** David Stoddart <[D.Stoddart@primetp.co.uk](mailto:D.Stoddart@primetp.co.uk)>  
**Subject:** RE: Halterworth Lane, Romsey

Morning David,

A belated Happy New Year – I hope you had a good break.

I have received an email from the case officer at TVBC asking me for an update on highway matters regarding the Halterworth appeal. She has noted that the County Council's witness statement will be required by 25<sup>th</sup> February should we seek to maintain our objection.

I therefore wanted to check in to see if you're able to provide any indication as to when you will be in a position to send over the revised package of information? As discussed when we met, and particularly now so given that the timescales are tight, if you are able to send over any drawings/information separately, I will work on getting this reviewed now.

Kind Regards,

**Chris Hirst**  
**Senior Transport Planner**  
[Chris.Hirst@hants.gov.uk](mailto:Chris.Hirst@hants.gov.uk)

**Highways Development Planning**  
Hampshire County Council  
2<sup>nd</sup> Floor Elizabeth II Court West  
The Castle Winchester SO23 8UD



## Hampshire County Council operates a pre-application highway advice service for developers.

Hampshire County Council welcomes and encourages discussions before a developer submits a planning application. Please follow this link for further information

[Pre-Application guidance for developers](#)

---

**From:** David Stoddart <[D.Stoddart@primetp.co.uk](mailto:D.Stoddart@primetp.co.uk)>

**Sent:** 06 December 2024 14:03

**To:** Hirst, Chris <[Chris.Hirst@hants.gov.uk](mailto:Chris.Hirst@hants.gov.uk)>

**Subject:** RE: Halterworth Lane, Romsey

**Caution:** This is an external email and could contain malicious content. Do not open any links or attachments if you were not expecting them. If the e-mail looks suspicious, please report via the 'Report Phishing' Button found on your toolbar.

Hi Chris,

Just one further update, the Tadburn path between Botley Road and Knatchbull Close/The Rapids Roundabout has been considered by Whitenap, as shown on the plan below, therefore we'll exclude it from our design work.



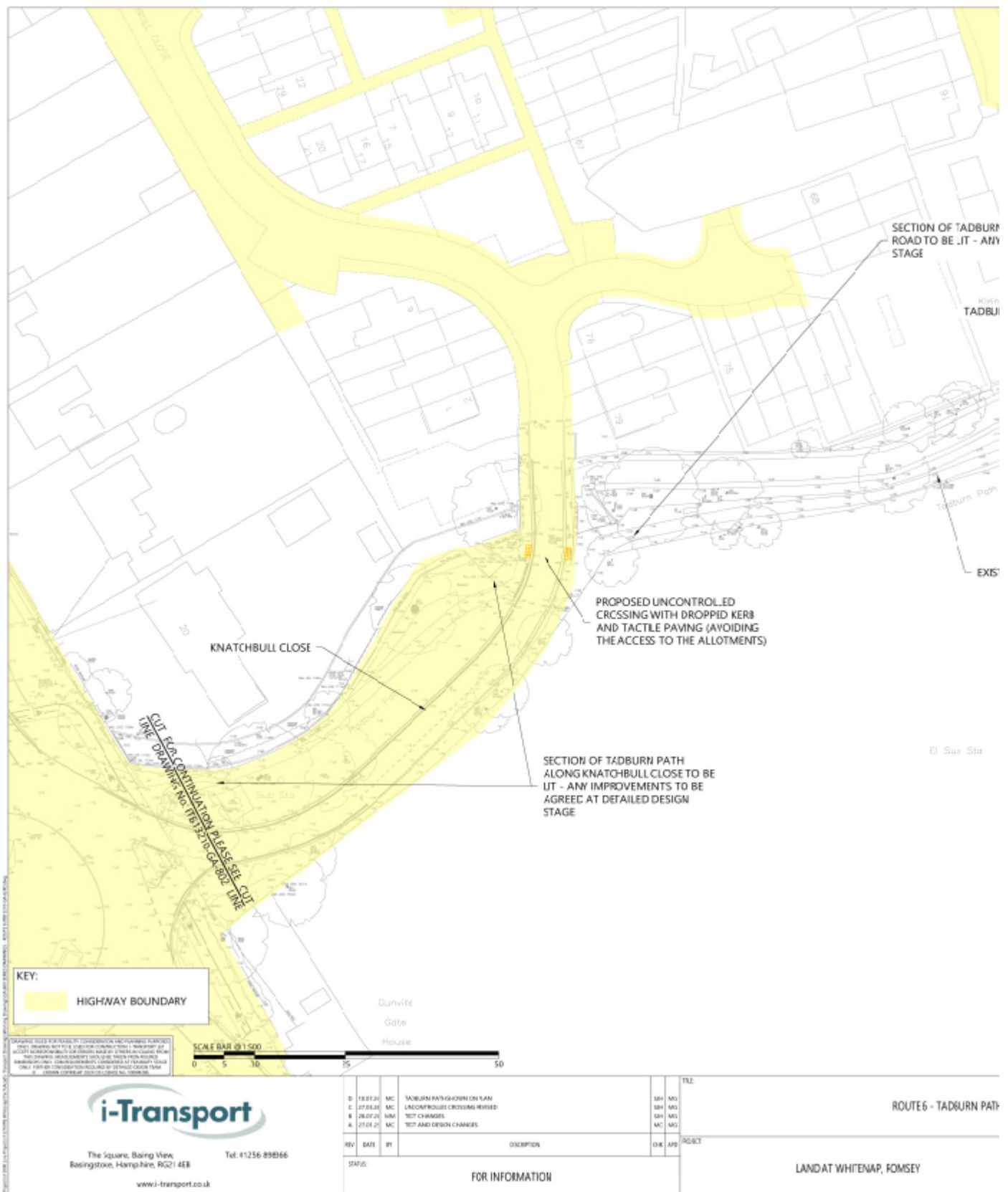

I've updated our Google Map for reference:

<https://www.google.com/maps/d/edit?mid=1u3MPdUprEWD5ZOHB94H8w3N77ZRmnal&usp=sharing>

Kind regards

Dave

**David Stoddart**

**Associate Director**

**D:** +44 (0)151 728 1864

**M:** +44 (0)7944 446 528

[www.primetp.co.uk](http://www.primetp.co.uk)

---

**From:** Hirst, Chris <[Chris.Hirst@hants.gov.uk](mailto:Chris.Hirst@hants.gov.uk)>

**Sent:** 05 December 2024 10:04

**To:** David Stoddart <[D.Stoddart@primetp.co.uk](mailto:D.Stoddart@primetp.co.uk)>

**Subject:** RE: Halterworth Lane, Romsey

Thanks for confirming David.

Kind Regards,

**Chris Hirst**

**Senior Transport Planner**

[Chris.Hirst@hants.gov.uk](mailto:Chris.Hirst@hants.gov.uk)

**Highways Development Planning**

Hampshire County Council

2<sup>nd</sup> Floor Elizabeth II Court West

The Castle Winchester SO23 8UD



**Hampshire County Council operates a pre-application highway advice service for developers.**

Hampshire County Council welcomes and encourages discussions before a developer submits a planning application. Please follow this link for further information

[Pre-Application guidance for developers](#)

---

**From:** David Stoddart <[D.Stoddart@primetp.co.uk](mailto:D.Stoddart@primetp.co.uk)>

**Sent:** 05 December 2024 10:02

**To:** Hirst, Chris <[Chris.Hirst@hants.gov.uk](mailto:Chris.Hirst@hants.gov.uk)>

**Subject:** RE: Halterworth Lane, Romsey

**Caution:** This is an external email and could contain malicious content. Do not open any links or attachments if you were not expecting them. If the e-mail looks suspicious, please report via the 'Report Phishing' Button found on your toolbar.

Hi Chris,

Many thanks for confirming. We'll get the topo survey organised asap.

Well spotted, I did update the map following the meeting as I took another look at the Whitenap proposals. The attached drawings show their suggested scheme for the section between the two roundabouts and the roundabouts themselves.

Kind regards

Dave

**David Stoddart**

**Associate Director**

**D:** +44 (0)151 728 1864

**M:** +44 (0)7944 446 528

[www.primetp.co.uk](http://www.primetp.co.uk)

---

**From:** Hirst, Chris <[Chris.Hirst@hants.gov.uk](mailto:Chris.Hirst@hants.gov.uk)>

**Sent:** 05 December 2024 09:56

**To:** David Stoddart <[D.Stoddart@primetp.co.uk](mailto:D.Stoddart@primetp.co.uk)>

**Subject:** RE: Halterworth Lane, Romsey

Hi David,

Thanks for sending this over.

As per our discussion, I am satisfied with you undertaking further work to look at pedestrian and cycle improvements on the routes highlighted in purple, red and orange (canal walk, Tadburn path, Botley Road corridor and Halteworth Lane to School Road).

Just one query at this stage, I note that you've included a section of blue line inbetween the Rapids Roundabout and the Plaza mini roundabout which is being attributed to Whitenap. This wasn't on the map yesterday, so I just wanted to ensure that Whitenap are proposing improvements here? If not, I would expect this section to also feature in the review you're undertaking.

Kind Regards,

**Chris Hirst**

**Senior Transport Planner**

[Chris.Hirst@hants.gov.uk](mailto:Chris.Hirst@hants.gov.uk)

**Highways Development Planning**

Hampshire County Council

2<sup>nd</sup> Floor Elizabeth II Court West

The Castle Winchester SO23 8UD



**Hampshire County Council operates a pre-application highway advice service for developers.**

Hampshire County Council welcomes and encourages discussions before a developer submits a planning application. Please follow this link for further information

[Pre-Application guidance for developers](#)

---

**From:** David Stoddart <[D.Stoddart@primetp.co.uk](mailto:D.Stoddart@primetp.co.uk)>

**Sent:** 04 December 2024 15:26

**To:** Hirst, Chris <[Chris.Hirst@hants.gov.uk](mailto:Chris.Hirst@hants.gov.uk)>

**Subject:** RE: Halterworth Lane, Romsey

**Caution:** This is an external email and could contain malicious content. Do not open any links or attachments if you were not expecting them. If the e-mail looks suspicious, please report via the 'Report Phishing' Button found on your toolbar.

Hi Chris,

Good to see you earlier, thanks for your time.

I've taken another look at the LCWIP and what Whitenap are proposing. In terms of the route to the train station you mentioned, Whitenap don't appear to be picking up the path between Botley Road and the A3090 which is part of Route 280 so we'll look at that. Then there's the path to the side and rear of the Plaza Theatre to the station. The canal towpath section is part of LCWIP Route 331.

I've added these to the plan I shared on screen earlier which you can see via the link below:

<https://www.google.com/maps/d/edit?mid=1u3MPdUprEWD5ZOHB94H8w3N77ZRmnaI&usp=sharing>

I'd be grateful if you could confirm that these two sections, in addition to the other red and orange lines showing sections of Routes 280 and 332 respectively, are the ones that we should focus on.

Kind regards

Dave

**David Stoddart**

**Associate Director**

**D:** +44 (0)151 728 1864

**M:** +44 (0)7944 446 528

[www.primetp.co.uk](http://www.primetp.co.uk)

---

**From:** Hirst, Chris <[Chris.Hirst@hants.gov.uk](mailto:Chris.Hirst@hants.gov.uk)>

**Sent:** 04 December 2024 09:16

**To:** David Stoddart <[D.Stoddart@primetp.co.uk](mailto:D.Stoddart@primetp.co.uk)>

**Subject:** RE: Halterworth Lane, Romsey

Sorry David – I haven't had an invite through? Not sure if it's a problem with my calendar.

Kind Regards,

**Chris Hirst**  
**Senior Transport Planner**  
[Chris.Hirst@hants.gov.uk](mailto:Chris.Hirst@hants.gov.uk)

**Highways Development Planning**  
Hampshire County Council  
2<sup>nd</sup> Floor Elizabeth II Court West  
The Castle Winchester SO23 8UD



**Hampshire County Council operates a pre-application highway advice service for developers.**

Hampshire County Council welcomes and encourages discussions before a developer submits a planning application. Please follow this link for further information

[Pre-Application guidance for developers](#)

---

**From:** David Stoddart <[D.Stoddart@primetp.co.uk](mailto:D.Stoddart@primetp.co.uk)>

**Sent:** 04 December 2024 09:12

**To:** Hirst, Chris <[Chris.Hirst@hants.gov.uk](mailto:Chris.Hirst@hants.gov.uk)>

**Subject:** RE: Halterworth Lane, Romsey

**Caution:** This is an external email and could contain malicious content. Do not open any links or attachments if you were not expecting them. If the e-mail looks suspicious, please report via the 'Report Phishing' Button found on your toolbar.

No problem, Chris. Hopefully the time has updated on the invite.

Speak to you later.

**David Stoddart**

**Associate Director**

**D:** +44 (0)151 728 1864

**M:** +44 (0)7944 446 528

[www.primetp.co.uk](http://www.primetp.co.uk)

---

**From:** Hirst, Chris <[Chris.Hirst@hants.gov.uk](mailto:Chris.Hirst@hants.gov.uk)>

**Sent:** 03 December 2024 18:38

**To:** David Stoddart <[D.Stoddart@primetp.co.uk](mailto:D.Stoddart@primetp.co.uk)>

**Subject:** Re: Halterworth Lane, Romsey

Hi David,

Could we say 14:00 in that case please? Gives me a little more time around meetings!

Thanks,

Chris

Sent from [Outlook for iOS](#)

---

**From:** David Stoddart <[D.Stoddart@primetp.co.uk](mailto:D.Stoddart@primetp.co.uk)>

**Sent:** Tuesday, December 3, 2024 3:33:41 PM

**To:** Hirst, Chris <[Chris.Hirst@hants.gov.uk](mailto:Chris.Hirst@hants.gov.uk)>

**Subject:** RE: Halterworth Lane, Romsey

**Caution:** This is an external email and could contain malicious content. Do not open any links or attachments if you were not expecting them. If the e-mail looks suspicious, please report via the 'Report Phishing' Button found on your toolbar.

Thanks Chris,

I appreciate it. I'll send you an invite for 13:00 tomorrow but feel free to change it. I'm free all afternoon up to 4pm and the same on Thursday.

Thanks

Dave

**David Stoddart**

**Associate Director**

**D:** +44 (0)151 728 1864

**M:** +44 (0)7944 446 528

[www.primetp.co.uk](http://www.primetp.co.uk)

---

**From:** Hirst, Chris <[Chris.Hirst@hants.gov.uk](mailto:Chris.Hirst@hants.gov.uk)>

**Sent:** 03 December 2024 14:48

**To:** David Stoddart <[D.Stoddart@primetp.co.uk](mailto:D.Stoddart@primetp.co.uk)>

**Subject:** RE: Halterworth Lane, Romsey

Hi David,

I'm free tomorrow afternoon between 13:00 – 16:00 or Thursday from 13:00 – 15:00, otherwise it'll have to be next week.

Feel free to send over a Teams invite if either day suits.

Kind Regards,

**Chris Hirst**

**Senior Transport Planner**

[Chris.Hirst@hants.gov.uk](mailto:Chris.Hirst@hants.gov.uk)

**Highways Development Planning**  
Hampshire County Council  
2<sup>nd</sup> Floor Elizabeth II Court West  
The Castle Winchester SO23 8UD



**Hampshire County Council operates a pre-application highway advice service for developers.**

Hampshire County Council welcomes and encourages discussions before a developer submits a planning application. Please follow this link for further information

[Pre-Application guidance for developers](#)

---

**From:** David Stoddart <[D.Stoddart@primetp.co.uk](mailto:D.Stoddart@primetp.co.uk)>

**Sent:** 02 December 2024 15:26

**To:** Hirst, Chris <[Chris.Hirst@hants.gov.uk](mailto:Chris.Hirst@hants.gov.uk)>

**Subject:** Halterworth Lane, Romsey

**Caution:** This is an external email and could contain malicious content. Do not open any links or attachments if you were not expecting them. If the e-mail looks suspicious, please report via the 'Report Phishing' Button found on your toolbar.

Hi Chris,

Hope you're well. I was hoping you might be able to spare 15-20 minutes or so this week to have a quick catchup on the Gladman site in Romsey? You may be aware that Gladman have appealed based on non-determination and we have a date for the public inquiry (25<sup>th</sup> March – 2<sup>nd</sup> April 2025).

Following our meeting at the end of July, I've taken a look at the updated plans for Whitenap and I think it'll be useful for us to have a chat before we come back to you with some additional information. I'm relatively free this week.

Thanks

Dave

**David Stoddart**  
Associate Director

**D:** +44 (0)151 728 1864

**M:** +44 (0)7944 446 528

9 Hurricane Court, Liverpool International Business Park  
Estuary Boulevard, Liverpool, L24 8RL



[www.primetp.co.uk](http://www.primetp.co.uk) 



Notice of Confidentiality. This communication and the information it contains: (a) is intended solely for the person(s) or Organisation(s) named above and for no other persons or organisations and, (b) maybe confidential, legally privileged and protected by law. Unauthorised use, copying or disclosure of any of it maybe unlawful. If you receive this communication in error, please notify us immediately, destroy any copies and delete it from your computer system.