

13 November 2025

As a new resident of Chantry Lodge, I am affected by the proposed Stopping Up order by TVBC. I object to the Stop Order for Western Avenue and West Street for the following reasons:

1. I have asked to see a plan for the 2 way West Street junction and Chantry Street at all meetings this year. TVBC have failed to supply this information. My concern is that traffic from Chantry Street and the Leisure Centre will have to cross 2 lanes of oncoming traffic.
2. Traffic numbers will vastly increase under the proposals as will noise and pollution. All traffic, including delivery lorries to Waitrose and Lidl, will make two journeys past Chantry Lodge and the Portland Grove. Currently the vast majority of the traffic to Lidl enters from Western Avenue and exits via the one way system, by the Bus Station, back onto Western Avenue.

I would propose that West St remain a one way street without any material difference to the park. In order to maintain good traffic flow Western Avenue already has 2 lanes from the Asda roundabout to the Folly roundabout. In the opposite direction there are 2 lanes currently present up to West Street plus the slip road which starts at the Chantry Multi Storey car park. It means therefore that 2 lanes can exist on both sides of Western Avenue without impacting the proposed park. The small section of Western Avenue past Lidl which is currently 2 lane, right through to the multi storey car park and beyond. The current one way system could allow 1 lane only from the Bus Station to the exit of the multi storey. The remainder of the road could be used as park land. I propose a new roundabout at the point where the exit roads would meet on the dual carriageway. In order to preserve pedestrian safety, a short underpass can be built towards The Town Mills park area.

Benefits of this proposal:

1. The park improvement would go ahead with little disruption to the proposed scheme.
2. All residents and drivers impacted by the proposals would use the 1 way system to the new roundabout.
3. My proposal would limit the Lidl lorry and car traffic by half, thereby reducing noise and pollution.
4. Traffic from Chantry Street would not have to cross 2 lanes of on coming traffic.
5. It would be safer for pedestrians from the College, Leisure Centre and residents as the pavements would not have to be reduced.

6. The new proposed roundabout would control the speed of vehicles on the dual carriageway.

20 November 2025

As requested I will provide further detail and objection based on 70 years of driving in UK, Europe Canada & America.

Andover has seen a steady increase in housing in the 20 years that we have lived here SEVERAL THOUSAND HOUSES HAVE BEEN BUILT IN THAT TIME.

THIS RESULTS IN MORE & MORE TRAFFIC.

Andover needs more dual carriageways --NOT LESS-- to take traffic both around Andover and to the A303 etc.

The proposal by Test Valley for a park extension ignores this fact . Some connecting roads have small sections of dual carriageway like the roads near the large Tesco.

Back to the Western Avenue however-

**Western avenue has dual carriageway from the Asda roundabout to the Folly Rbt - some 700yds I would guess in Both directions (APART FROM 100yds)**

they are proposing A single lane in each direction in place of the essentially 2 lanes in both directions

This will delay traffic and make the task of the ambulance & fire service to get from Asda Rbt to the Hospital or out to an emergency call on the A303 very difficult indeed.

1. All they have to do to is --continue the 2 lanes from the Folly rbt-- past the start of West St towards to the traffic lights and rbt at Asda ----is to utilise the current slip road from the opposite direction into West Street (100yds)-- then build a lane alongside it towards the traffic lights near ASDA. My proposal for the one way West St is to have a single lane towards the exit from the multi-storey car park where all traffic going forward to a new roundabout into Western Ave. This is practical as there is ample space where the roads meet now and would improve the safety for cars wanting to turn right towards the Folly or hospital based on right of way.
2. The park would lose the space of 100 yds or so of current slip road and the new lane alongside providing a straight run to Asda Rbt.
3. However the would gain THE 2 LANES OF WESTERN AVE WHICH ARE CURRENTLY DIVERTED AROUND PAST LIDL UP TO THE EXIT FROM THE CAR PARK.

4. Please look at the proposed map and hopefully these ideas will make sense. It might also be somewhat less expensive but I don't have any figures to work on.

7 December 2025

Please find attached a map which retains the one way traffic flow in West Street with a single lane to the new proposed roundabout on Western Avenue. My attached notes highlight the significant advantages to this proposed scheme without affecting the park.

Thank you for giving this your attention and please contact me if I can be of further assistance.

**TRAFFIC FLOW PROPOSALS TO SUPPORT RETENTION OF ONE-WAY SYSTEM IN WEST STREET:**

**Rationale:** Utilise an R/A Layout at the southern end of the current 'island'.

- Create 30mph mini urban clearway in Western Avenue for through traffic devoid of Traffic Lights;
- Eliminate Right Hand Turns off Western Avenue into West Street and on exit of West Street;
- Introduce One way functionality in West Street additionally for Waterloo Court and Chantry Centre Multi-Storey Car Park for those vehicles already in West Street.

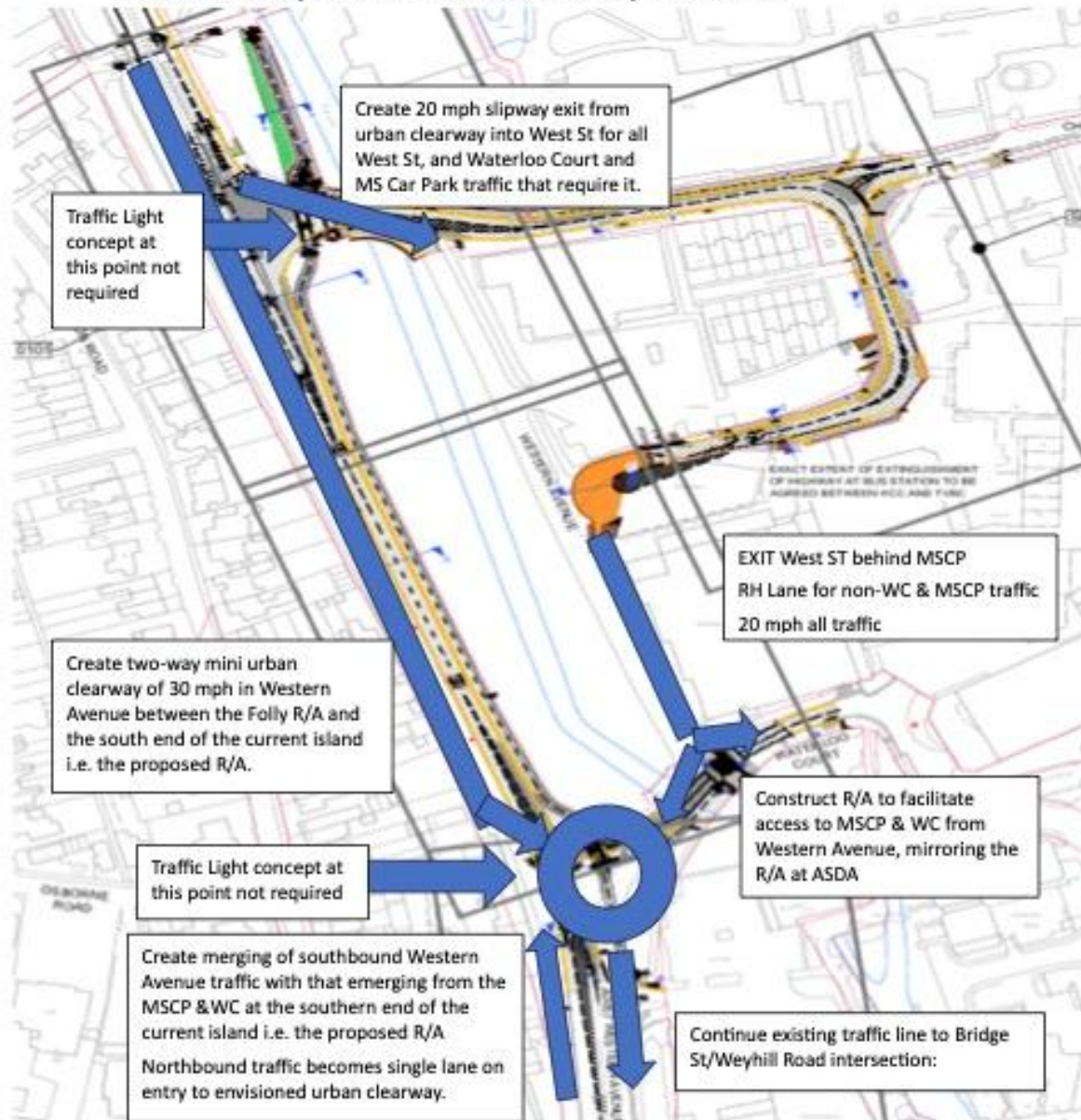

**BENEFITS:**

- This concept could be trialled with minimum interference with existing traffic flows by actually closing the southbound Gyratory to effect same and utilising a temporary R/A configuration;
- This arrangement frees all central Andover traffic to facilitate actions by the Emergency Services.

### Proposal to retain one way system in West Street Andover

This proposed retention of the one way system will mitigate the problems of Traffic Flow, Pollution, Safety and Noise which, it is believed will occur with the Proposed Stopping Up Order for West Street.

**Traffic Flow:** The attached map shows a slip road from the current dual carriageway into West Street. This will enable good traffic flow without the need for the proposed traffic lights. West Street then continues one way to a new roundabout at the junction from MSCP and Western Avenue.

Under the Stopping Up Order, all Emergency Services would only have one entry/exit. If West Street needed to be blocked off in an emergency some vehicles would be unable to exit. This would mean that residents and people using the facilities would be unable to exit except on foot. (A recent example, the Fire Service shut off West Street at the back of Lidl). All traffic from residents, Lidl customers, disabled drivers from the Leisure Centre plus the buses would be trapped.

In addition, if there was an incident on Western Avenue urban clearway and the road was closed. This new one way road proposal would allow traffic from The Folly roundabout to use the slip road into West Street. The traffic turning left onto Western Avenue from Weyhill Road would be able to use the new proposed roundabout to avoid the incident. This would clear any congestion to make easier access for all emergency vehicles.

The map shows that with adjustments for buses and large delivery lorries they would be able to exit via the new roundabout. This would allow all traffic the ability to turn both left and right onto Western Avenue, which significantly improves traffic flow.

**Other benefits:** There would be no requirement to reduce the width of the pavements in West Street which would cause safety issues for mobility scooters and pushchairs. This scheme would prevent traffic having to cross on coming traffic, to enter Lidl car park and Portland Grove. Traffic from the disabled parking bays at Leisure Centre and from Chantry Street would not have to cross oncoming traffic to exit West Street.

There are 5 delivery yards in West Street and Chantry Street, all these lorries would not have to cross oncoming traffic from their delivery yards, endangering cyclists and pedestrians. The entrance to Lidl from Western Avenue will be closed. Under this proposal this traffic will only use West Street once therefore reducing noise, pollution and improve safety for residents and pedestrians.